

## 2021 IECC Climate Zone 4B: Vented Cathedral Ceiling, 2x6 Wall, Slab on Grade

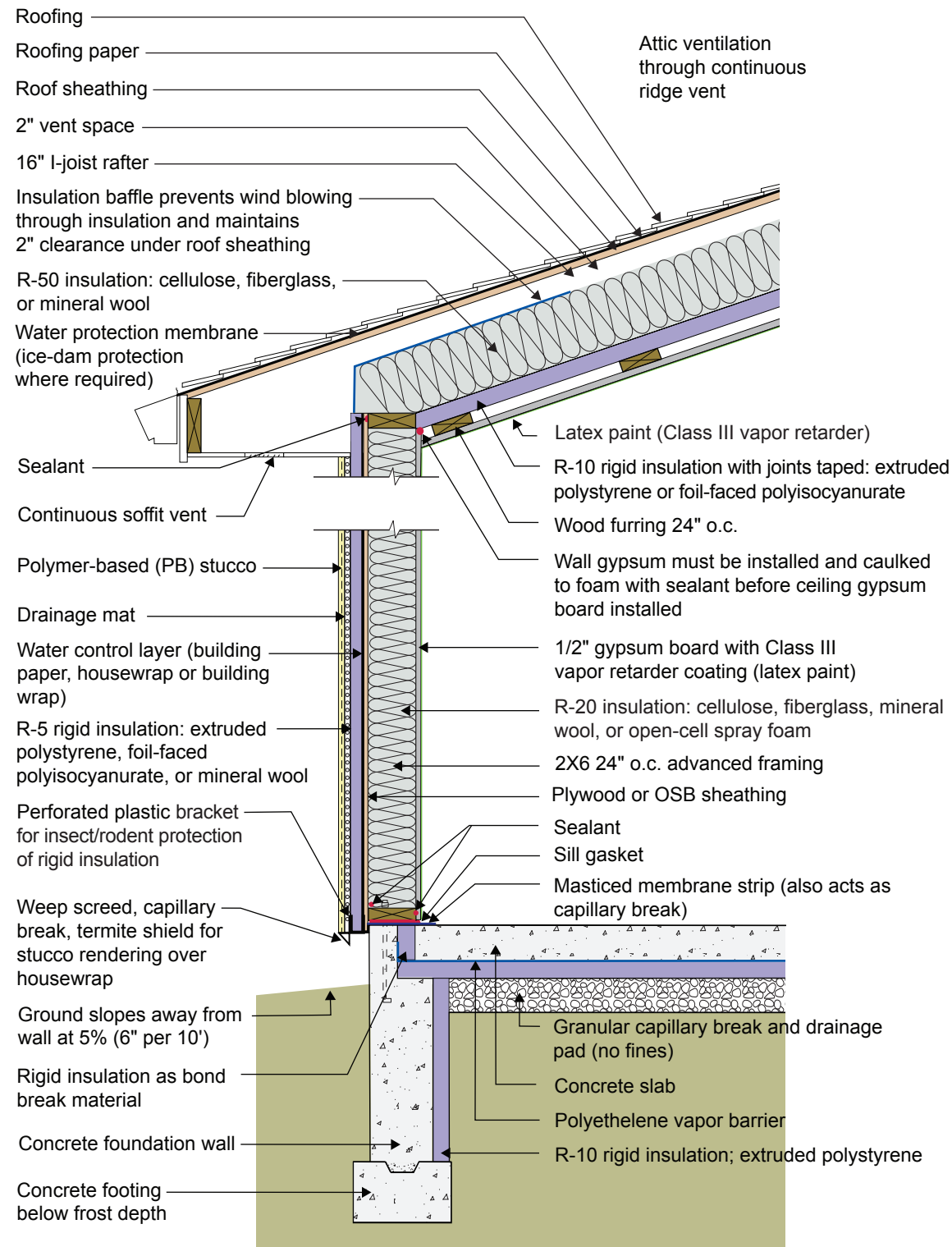

## 2021 IECC Climate Zone 4B: Vented Cathedral Ceiling, 2x6 Wall, Slab on Grade

- The R-10 rigid foam at the ceiling is not required for vapor control in Climate Zone 4, though it does aid this purpose by reducing vapor transport into the attic. It is used in this assembly to bring the total roof R-value up to the 2021 IECC requirement of R-60. Because the I-joint rafter is 16 inches and a 2-inch ventilation space is needed above the insulation, only about 14 inches are available for the fibrous cavity insulation. This will typically give an R-value of about R-50, leaving the need for the R-10 rigid foam. Note that only 1 inch of ventilation space above the cavity insulation is required by code, but 2 inches is recommended in areas where ice damming could be an issue or where rafter spans are long. The rigid foam at the ceiling is also used to allow the creation of a service raceway between the rigid foam and the gypsum board below it. The rigid foam acts as the air control layer instead of the gypsum board. The service raceway allows the air control layer to be undisturbed by the electrical penetrations in the ceiling. A third purpose of the rigid foam in this application is that it also reduces drywall cracking. From a vapor control standpoint, however, the rigid foam and the raceway are not required by 2021 IRC, and R-60 fibrous cavity insulation could be installed directly on top of the gypsum board if cavity height allows and if the attic is properly ventilated. In this case the gypsum board would become the air control layer and would need to be carefully sealed.
- The R-5 rigid insulation on the exterior of the wall framing is not only required per 2021 IECC, but it is also recommended to control condensation within the framing cavities as there is no interior vapor barrier – there is a Class III vapor “retarder” (semi-permeable latex paint). The reason that there is no interior vapor barrier is to permit drying to the interior.
- The plastic L-bracket at the bottom of the wall’s exterior rigid insulation should be perforated to facilitate drainage.
- The function of the masticed membrane strip under the wall bottom plate is to control entry of termites. It must be fully adhered. Some termite control approaches use a strip of stainless steel mesh embedded with mastic.
- It is not required by code to have both vertical and horizontal foundation insulation as is shown in the drawing. The horizontal insulation on the underside of the concrete floor slab is provided for comfort reasons and to control dust mites in carpets by reducing the relative humidity within the carpets.