

2021 IECC Climate Zone 4A: SIP Roof, SIP Wall, Stem Wall, Slab on Grade

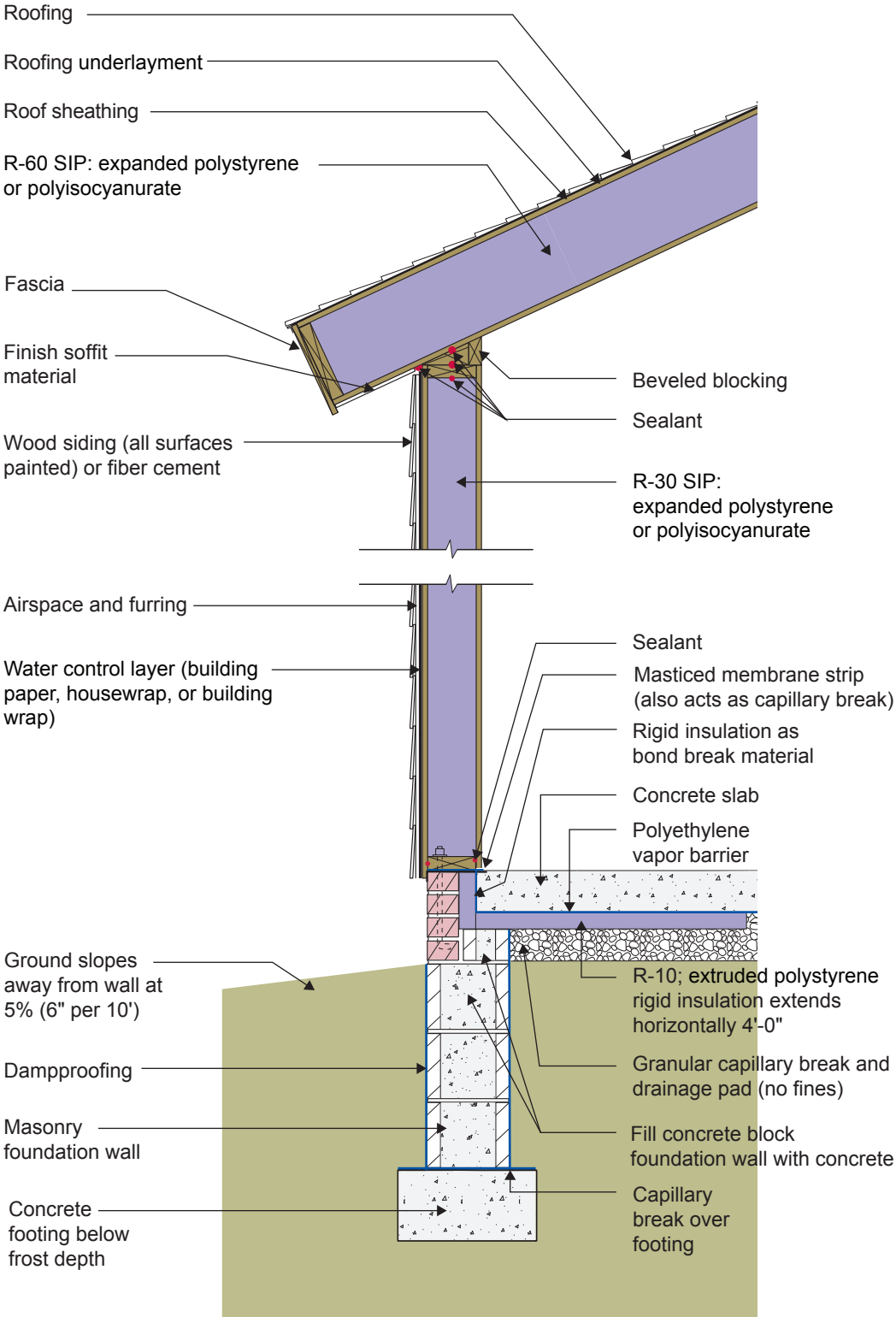

2021 IECC Climate Zone 4A: SIP Roof, SIP Wall, Stem Wall, Slab on Grade

- This wall and roof assembly is constructed using structural insulated panels (SIPs).
- It is important to seal the interior joints of the SIP roof panels to provide air control layer continuity.
- A drainage plane should be created behind the siding by using a draining house wrap or furring strips. Furring strips only need to create a gap of at least 1/4", so a material such as sill gasket strips installed vertically can be used in place of typical wood furring.
- The function of the masticed membrane strip under the sill plate is to control entry of termites. It must be fully adhered. Some termite control approaches use a strip of stainless-steel mesh embedded in mastic.
- Portions of the CMU wall may need to be filled solid to meet structural requirements or to accommodate anchor bolts for a sill plate.
- The entire below-grade portions of the stem wall should be coated with dampproofing to control capillary uptake.